

ROOM		SCHEDULE	
No.	Name	No.	Name
601	Vestibule	631	Marketing
602	Poyer	632	Storage
603	Corridor	633	Machines
604	Lecture	634	Business
605	Storage	635	Typing
606	Corridor	636	Vestibule
607	Office	637	Listening
608	Office	638	Office
609	Office	639	Storage
611	Office	641	Hall
612	Office	642	Dark Room
613	Office	643	Office
614	Office	644	Men
615	Office	645	Women
616	Office	646	Display
617	Office	647	Library
618	Office	648	Seminar
619	Corridor	649	Work Room
621	Reception	651	Office
622	Work Room	652	Office
623	Office	653	Study
624	Office	654	Micro
625	staff	655	Typing
626	Toilet	656	Study
627	Vestibule	657	Study
628	Mechanical	658	Study
629	Corridor	M661	Mechanical

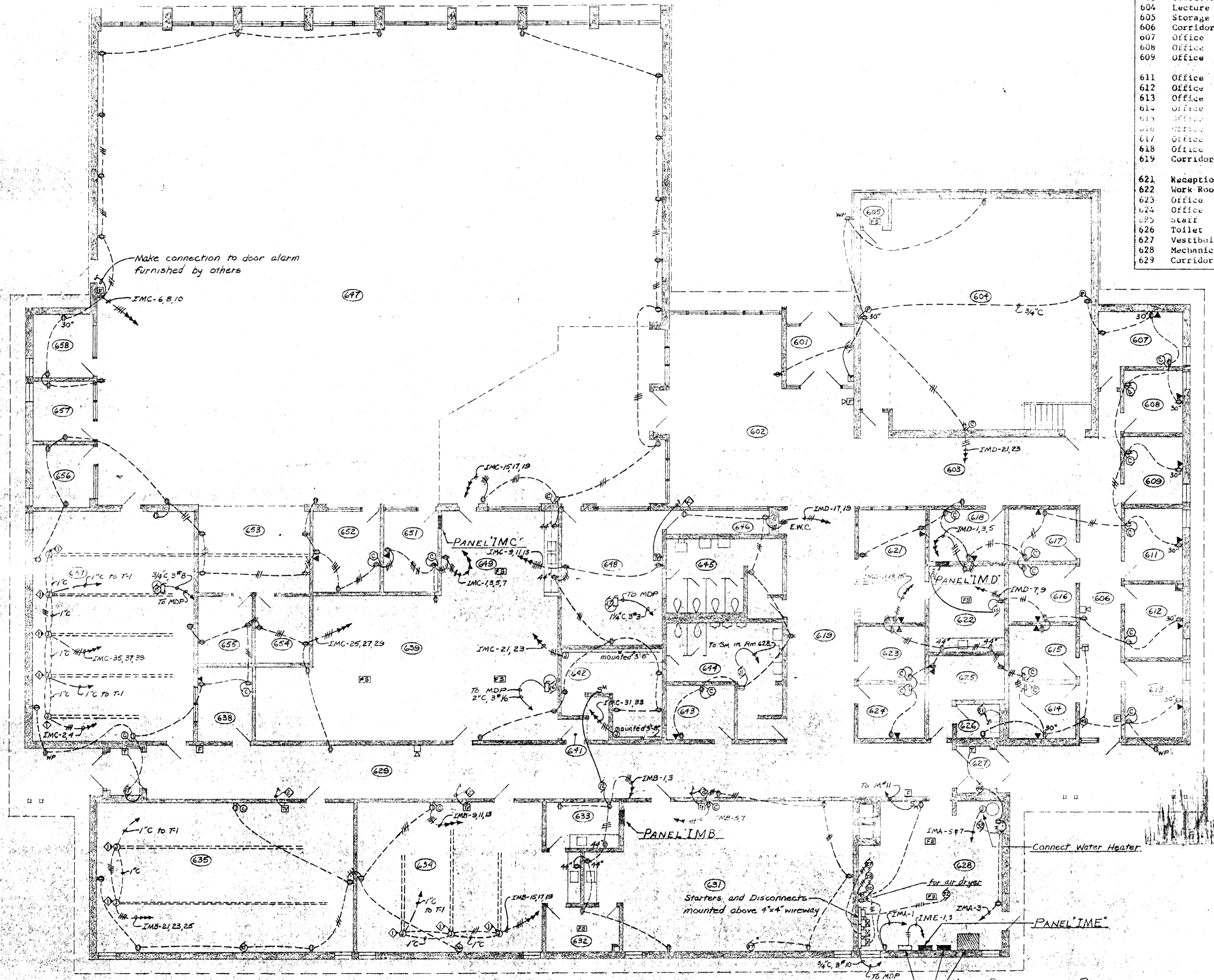

NOTES:  
 ⬢ Junction box mounted in tunnel  
 ⬢ 1/2" stub up and terminate with bushing above ceiling corridor.

LIBRARY FLOOR PLAN - POWER AND SYSTEMS 1  
 Scale: 1/8" = 1'-0"

HUMANITIES & INSTRUCTIONAL MEDIA CENTERS		DRAWN R.R.
STATE JUNIOR COLLEGE		
FERGUS FALLS, MINNESOTA		CHECKED G.L.O.
Kegel Associates ARCHITECTS DETROIT LAKES, MINNESOTA		AUGUST, 1970

YRAB8113 2111MAM JHE  
 ORPI